

# MB1-N



## Intuitive Operation

Plug and play design for easy set up

## Simplifies Maintenance

Built with high-efficiency components and few wear parts

## Production Versatility

Designed for use in many industries and applications

## Operator Friendly

Easy to operate with simple controls

# MB1-N

## Automatic off-line strapping machine



### Features and Benefits

- MS Arch and Steel dispenser for durability and longevity
- Robust and reliable strapping head
- Faster response time and strapping speed
- User friendly adjustment and operation
- Separate tool kit for easy maintenance
- Heavy duty heater
- Easy loading and unloading of strap
- Caster wheels for easy shop floor movement
- Low maintenance cost
- Tension controller inside the machine
- Smoke exhaust system
- Door with electric interlocks for safer operations
- 3 modes of operation - Cycle on / Table top / Foot Pedal switch

### Chute / Arch Sizes

| W    | 650 | 850 | 1050 | 1250 | 1450 | 1650 | 1850 | 2050 |
|------|-----|-----|------|------|------|------|------|------|
| H    |     |     |      |      |      |      |      |      |
| 400  | *   | *   | *    | *    | *    | *    | ☆    | ☆    |
| 600  | *   | S   | *    | *    | *    | *    | ☆    | ☆    |
| 800  | *   | *   | *    | *    | *    | ☆    | ☆    | ☆    |
| 1000 | *   | *   | *    | *    | ☆    | ☆    | ☆    | ☆    |
| 1200 | *   | *   | *    | ☆    | ☆    | ☆    | ☆    | ☆    |
| 1400 | *   | *   | ☆    | ☆    | ☆    | ☆    | ☆    | ☆    |
| 1600 | ☆   | ☆   | ☆    | ☆    | ☆    | ☆    | ☆    | ☆    |
| 1800 | ☆   | ☆   | ☆    | ☆    | ☆    | ☆    | ☆    | ☆    |
| 2000 | ☆   | ☆   | ☆    | ☆    | ☆    | ☆    | ☆    | ☆    |
| 2200 | ☆   | ☆   | ☆    | ☆    | ☆    | ☆    | ☆    | ☆    |
| 2400 | ☆   | ☆   | ☆    | ☆    | ☆    | ☆    | ☆    | ☆    |

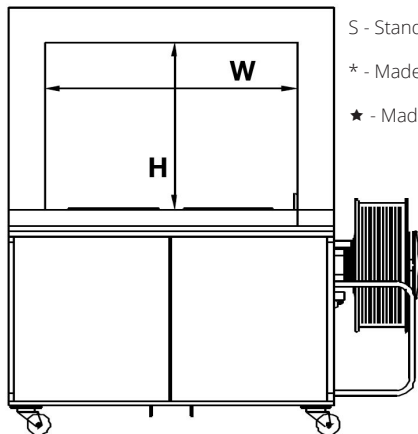

S - Standard machine model

\* - Made to order.

★ - Made to order, arch motor required.

### Technical Specifications & Dimensions

|                    |                                     |
|--------------------|-------------------------------------|
| Power Supply       | 415 Volt, 3 Phase, 50 Hz            |
| Power Consumption  | 0.85 KW                             |
| Strapping Speed    | 1.9 Sec / Cycle, 1920 Cycles / Hour |
| Strapping          | 9mm / 12mm / 15mm                   |
| Strap Tension      | 0.5 to 70 Kg                        |
| Package Size (Min) | 100mm Width x 30mm Height           |
| Package Size (Max) | Refer to Chute Arch Sizes           |
| Package Weight     | 5 to 40 Kg                          |
| Table Top Height   | 810mm to Floor                      |
| Color              | Body -Slate Grey, Arch - Jet Black  |

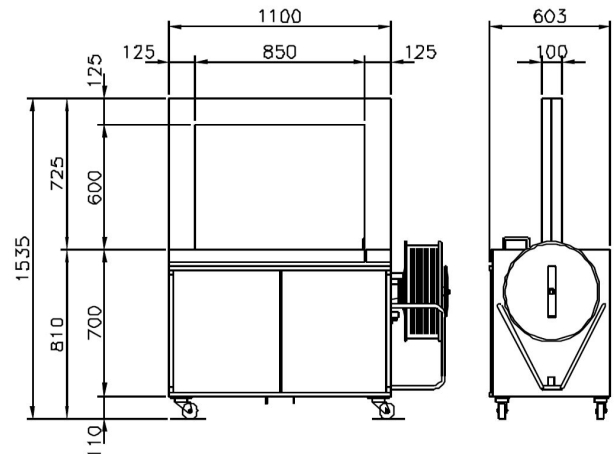

### Machine Options

- Ball table top for package over 40Kg in weight
- Automatic strap feeding mechanism

The company reserves the right to make technical alterations without prior notification. © 2025 Signode Industrial Group LLC / ID-20269/ REV-251117/ [www.Signode.com/en-in/](http://www.Signode.com/en-in/) For queries please contact Signode Industrial group LLC at [info.india@signode.com](mailto:info.india@signode.com)

