

MB-1



MB-1

Automatic off-line strapping machine

Intuitive Operation

Plug and play design for easy set up

Simplifies Maintenance

Built with high-efficiency components and few wear parts

Production Versatility

Designed for use in many industries and applications

Operator Friendly

Easy to operate with simple controls and intuitive stretch film replacement

MB-1

Automatic off-line strapping machine



Features and Benefits

- MS Arch and Steel dispenser for durability and longevity
- Robust and reliable strapping head
- Faster response time and strapping speed
- User friendly adjustment and operation
- Separate tool kit for easy maintenance
- Heavy duty heater
- Easy loading and unloading of strap
- Caster wheels for easy shop floor movement
- Low maintenance cost
- Tension controller inside the machine
- Smoke exhaust system
- Door with electric interlocks for safer operations
- 3 modes of operation - Cycle on / Table top / Foot Pedal switch

Chute / Arch Sizes

W	650	850	1050	1250	1450	1650	1850	2050
H								
400	*	*	*	*	*	*	☆	☆
600	*	S	*	*	*	*	☆	☆
800	*	*	*	*	*	☆	☆	☆
1000	*	*	*	*	☆	☆	☆	☆
1200	*	*	*	☆	☆	☆	☆	☆
1400	*	*	☆	☆	☆	☆	☆	☆
1600	☆	☆	☆	☆	☆	☆	☆	☆
1800	☆	☆	☆	☆	☆	☆	☆	☆
2000	☆	☆	☆	☆	☆	☆	☆	☆
2200	☆	☆	☆	☆	☆	☆	☆	☆
2400	☆	☆	☆	☆	☆	☆	☆	☆

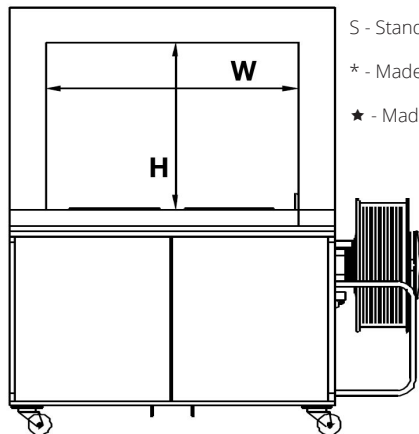

S - Standard machine model

* - Made to order.

★ - Made to order, arch motor required.

Technical Specifications & Dimensions

Power Supply	415 Volt, 3 Phase, 50 Hz
Power Consumption	0.85 KW
Strapping Speed	1.9 Sec / Cycle, 1920 Cycles / Hour
Strapping	9mm / 12mm / 15mm
Strap Tension	0.5 to 70 Kg
Package Size (Min)	100mm Width x 30mm Height
Package Size (Max)	Refer to Chute Arch Sizes
Package Weight	5 to 40 Kg
Table Top Height	810mm to Floor
Color	Body -Slate Grey, Arch - Jet Black

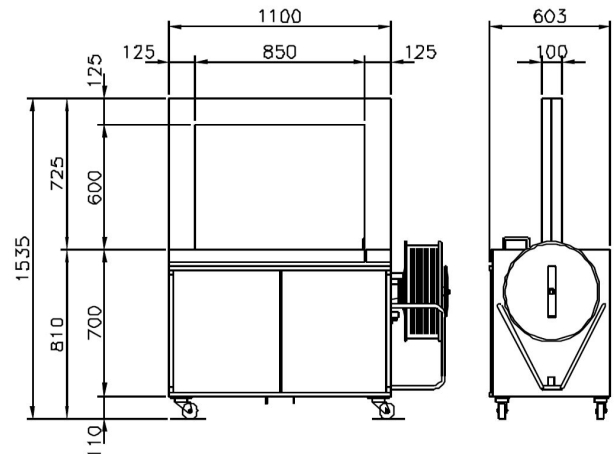

Machine Options

- Ball table top for package over 40Kg in weight
- Automatic strap feeding mechanism

The company reserves the right to make technical alterations without prior notification.
 © 2025 Signode Industrial Group LLC / ID-11781 / REV-250430/ www.Signode.com/en-in/
 For queries please contact Signode Industrial group LLC at info.india@signode.com

